

# COMMUNITY CENTER

## VIRTUAL COMMUNITY MEETING

JANUARY 7, 2021 | 6:00pm - 7:00pm on Zoom  
*A partnership of Mercy Housing and Related CA*



Interpretation

**Select the globe icon to listen to a Spanish or Chinese interpreter.**

選擇地球圖示收聽西班牙文或中文翻譯

基於技術故障，收聽國語人士，請按日本語 (Japanese)

**Seleccione el icono del globo para escuchar a un intérprete en español o chino.**

**Filifili le fa'aailoga e te fa'alogo i fa'aliliuga fa'a Sipasiolo, Samoa ("German") po'o Saina**

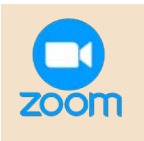

# ZOOM MEETING GUIDELINES

**We want to hear from you and see you!**

**Please keep your video on if possible.**

To download this presentation visit: <https://www.gosunnydale.org/community>

**After the presentation there will be *two ways* to give input:**

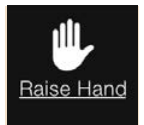

## **Raise your hand to speak**

Using the Zoom hand raising function.

Everyone will be muted until they are called on to speak.  
Please share your name the first time you speak.

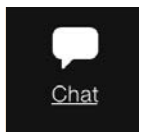

## **Enter your questions or comments into the chat.**

Questions will be read and answered aloud during the discussion after the presentation.

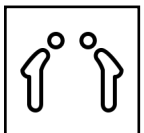

## **Please Respect Protocols**

# AGENDA

1. Introduction | [Mercy](#)
2. Project Vision & Project Schedule | [Mercy](#)
3. What We Heard from Past Community Engagements - Our Guiding Principles | [LMS](#) / [ACLA](#)
4. Update on Landscape Design: Final Schematic Design | [ACLA](#)
5. Update on Community Center: Final Schematic Design | [LMS](#)
6. Discussion & Questions | [Mercy](#), [LMS](#) & [ACLA](#)
7. Next Steps | [Mercy](#)

# TODAY'S PRESENTERS



**DANIELLE TATE**

*ASSOCIATE  
PROJECT MANAGER*

MERCY  
HOUSING



**EMILY RYLANDER**

*PRINCIPAL &  
PROJECT MANAGER*

ANDREA  
COCHRAN  
LANDSCAPE  
ARCHITECTURE



**GREGG NOVICOFF**

*ASSOCIATE PRINCIPAL  
& PROJECT MANAGER*

LEDDY  
MAYTUM  
STACY  
ARCHITECTS

**IN COLLABORATION WITH:**



PROYECTO





# VISION STATEMENT



EXISTING AERIAL VIEW LOOKING WEST



MASTER PLAN VIEW LOOKING WEST

THE COMMUNITY CENTER / HERZ PARK NEIGHBORHOOD CAMPUS AND THE NEW DEVELOPMENT AT THE HUB WILL BE:

AN **INCLUSIVE, SAFE, FRIENDLY, FAMILY- AND YOUTH- FOCUSED** PLACE FOR NEIGHBORHOOD RESIDENTS AND VISITORS.

**ACTIVE** WITH NEIGHBORHOOD SERVICES AND RECREATIONAL FACILITIES THAT WILL FACILITATE NEIGHBOR-TO-NEIGHBOR CONNECTIONS, EMPATHY AND TRUST, AND ENABLE INDIVIDUALS TO FEEL VALUED AND EMPOWERED TO MAKE POSITIVE CHANGE.

THE **HEART** OF THE NEIGHBORHOOD AND REFLECT THE RICHNESS OF A RACIALLY AND ETHNICALLY DIVERSE MIXED-INCOME COMMUNITY.



# PROJECT SCHEDULE





# CREATING A SHARED VISION

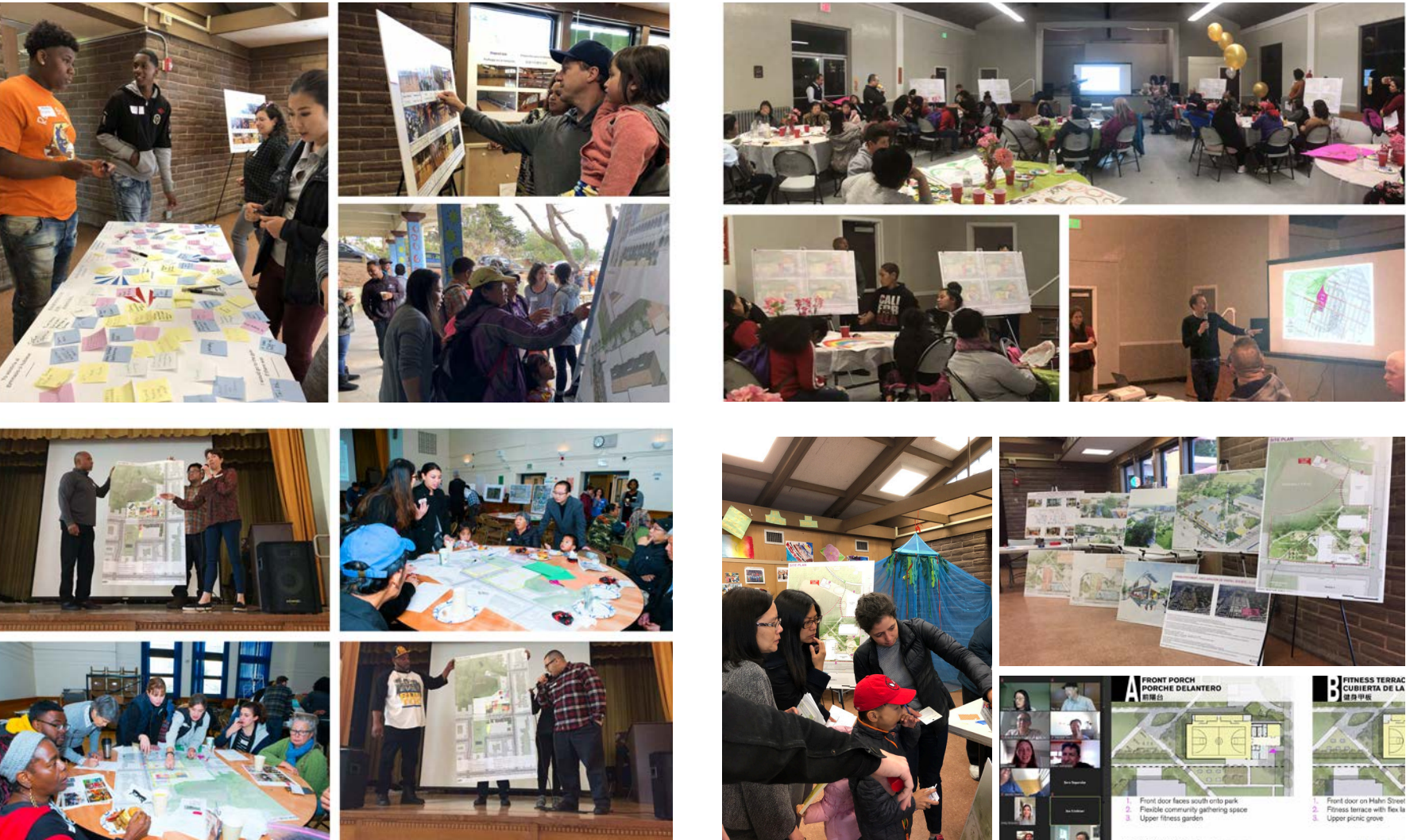

2018

YOUTH LEADERSHIP TEAM  
AUGUST 2018

OPEN HOUSE  
SEPTEMBER 2018

WORKSHOP #1  
DECEMBER 2018

2019

WORKSHOP #2  
FEBRUARY 2019

VIS VALLEY FOCUS GROUP  
FEBRUARY 2019

FAMILY DAY  
MAY 2019

HERZ COMMUNITY MEETING 1  
JUNE 2019

HERZ COMMUNITY MEETING 2  
JUNE 2020

STAKEHOLDER MEETINGS +  
FOCUS GROUPS  
AUGUST 2020

2021

TODAY

COMMUNITY CENTER  
VIRTUAL COMMUNITY  
MEETING  
WINTER 2021



# GUIDING PRINCIPLES

Establish an **active** street identity and site presence

Create a **welcoming** invitation and **gateway** to the park

Offer **safe** exterior spaces with **indoor / outdoor** connections

Connect to **nature** with daylight, views and access

Create **simple** and **flexible** solutions

Promote a healthy, resource efficient and **regenerative** community center & gym

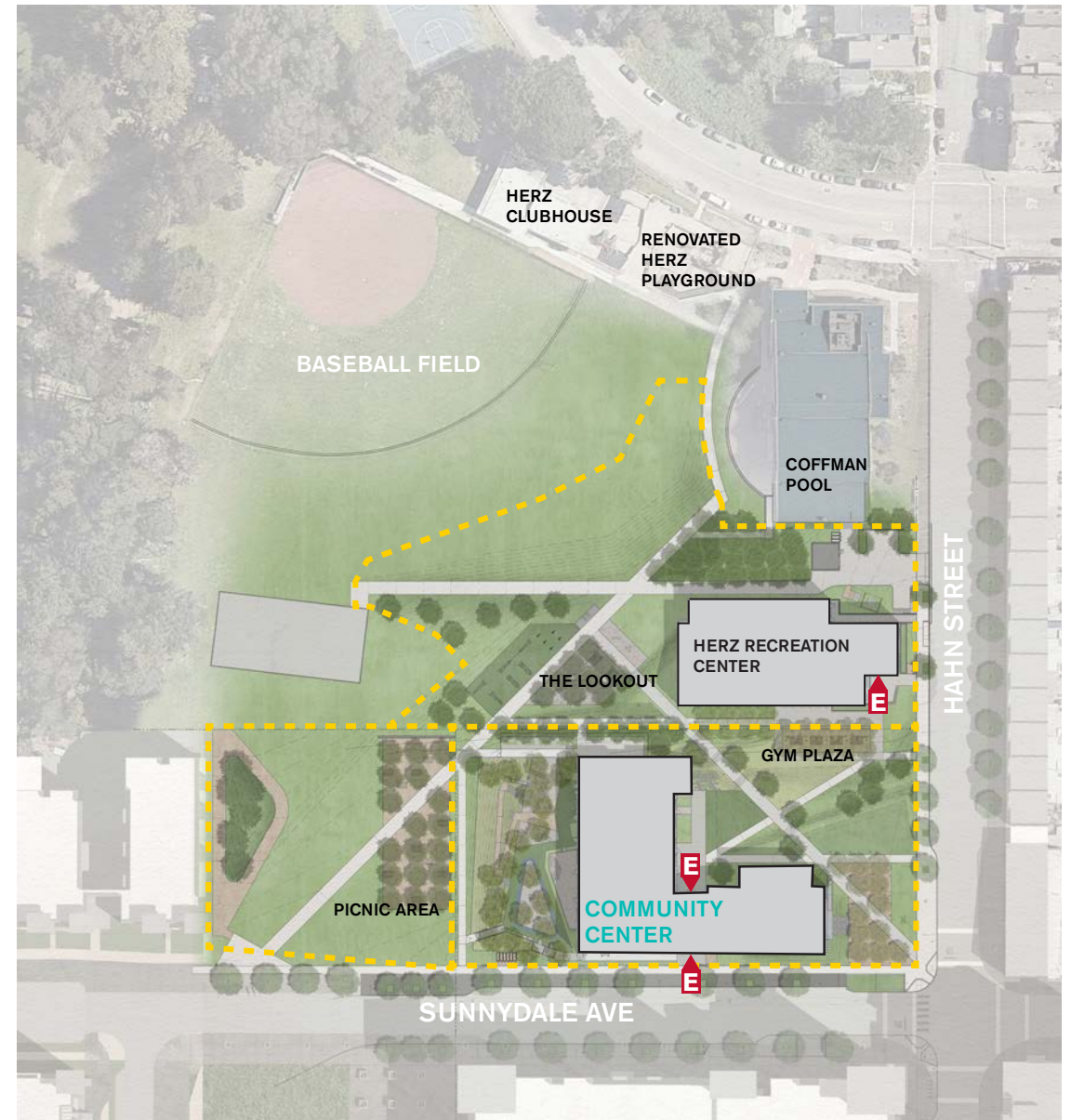



# EXISTING CONDITIONS: A PARK WITH GREAT POTENTIAL

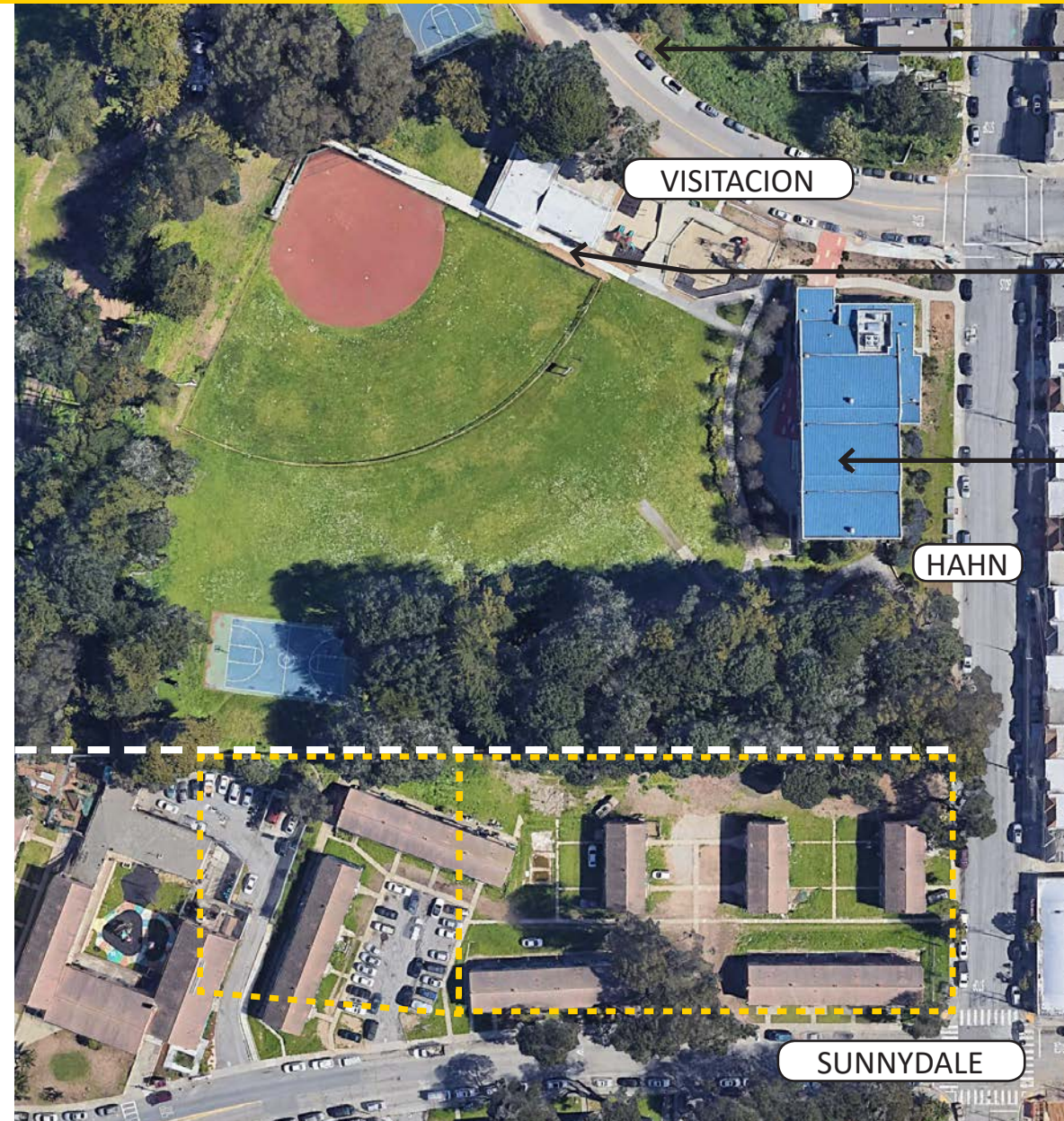
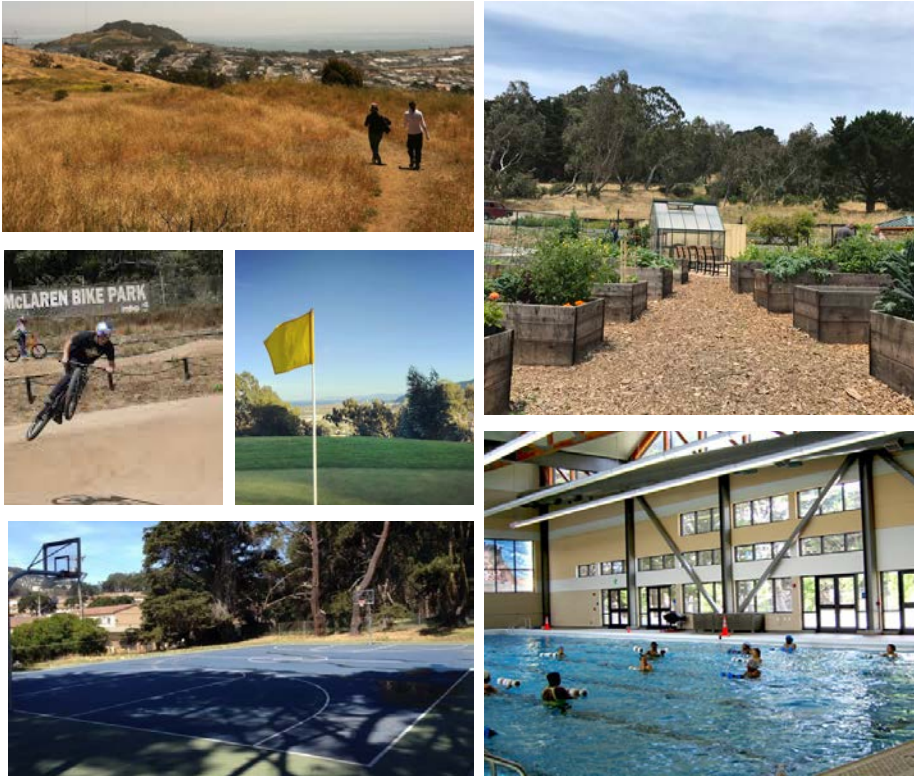

COMMUNITY  
GARDEN

CLUBHOUSE

COFFMAN  
POOL

HAHN

SUNNYDALE



# IMPROVEMENTS GOAL: AN INTEGRATED + VIBRANT COMMUNITY PARK



PLAYGROUND



RECREATION CENTER



COMMUNITY CENTER

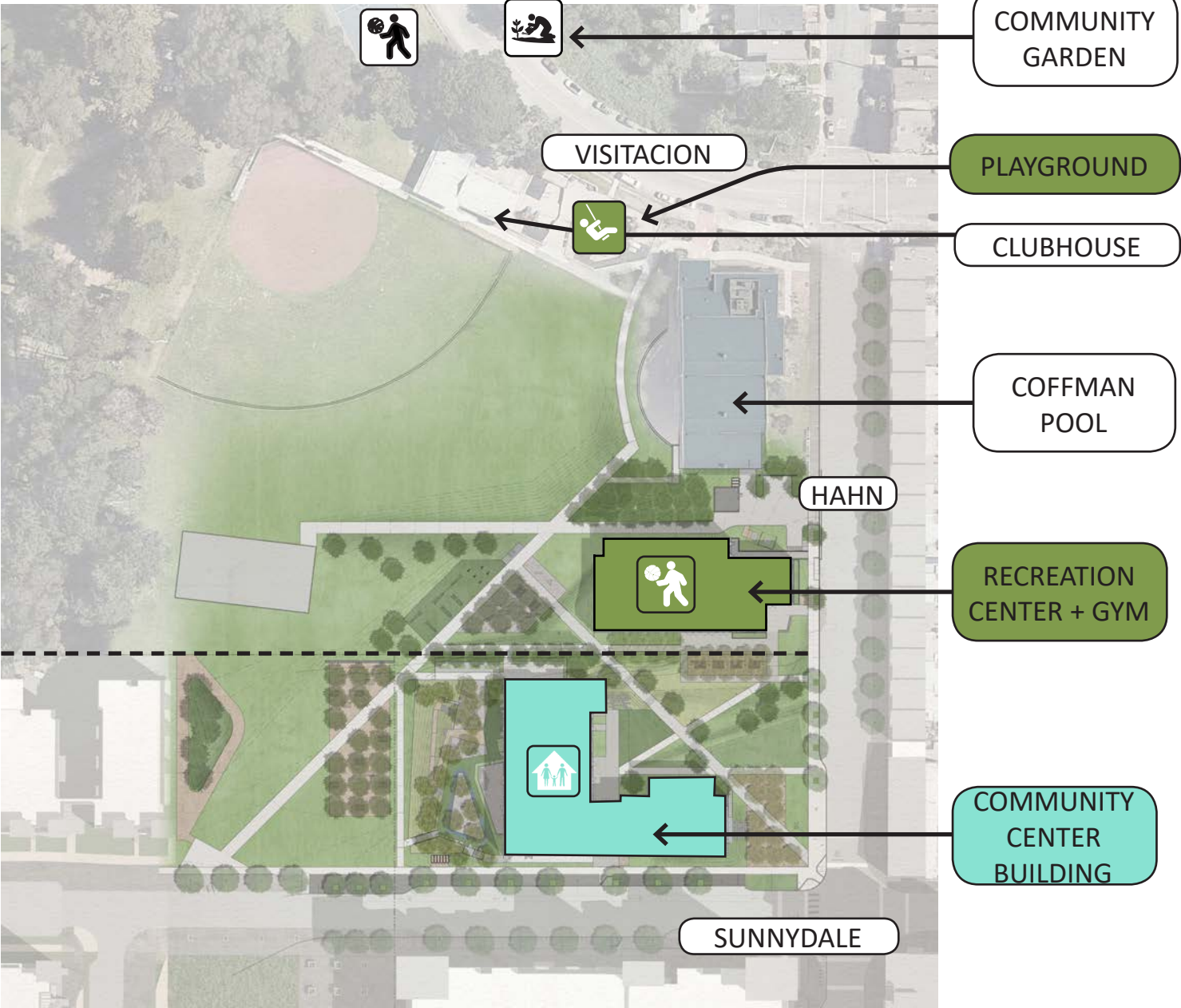

# IMPROVEMENTS GOAL: AN INTEGRATED + VIBRANT COMMUNITY PARK



PATHWAYS + CONNECTIONS



OUTDOOR FITNESS



GATHERING SPACES

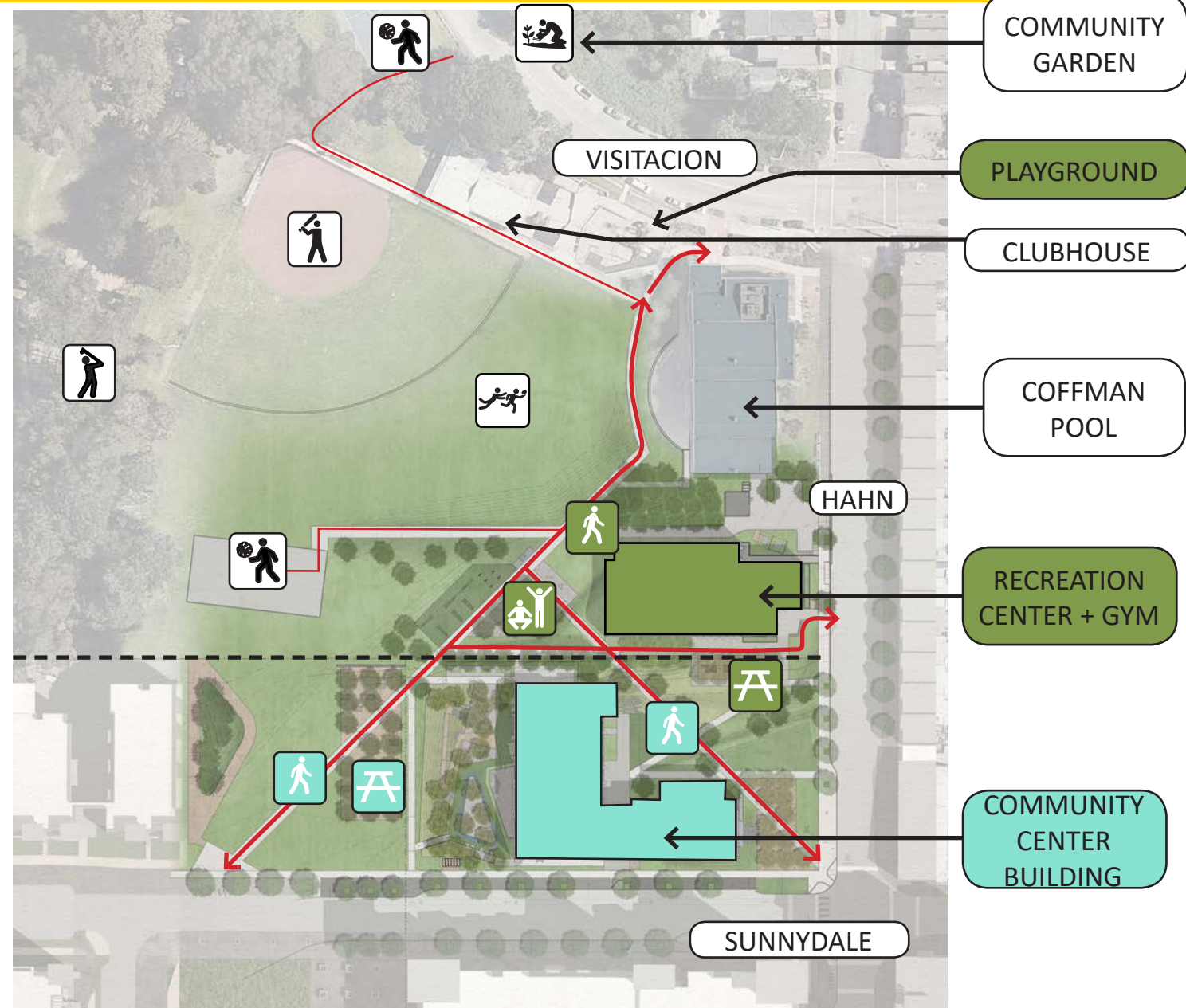



# WHAT WE HAVE HEARD FROM PAST MEETINGS: EXTERIOR SPACES

■ YOUTH ■ SENIORS ■ ADULTS

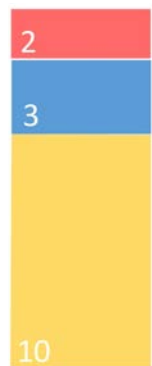

COMMUNITY  
GATHERING & BBQ

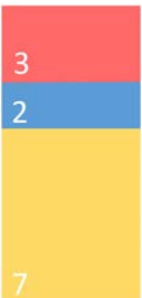

PICNIC LAWN

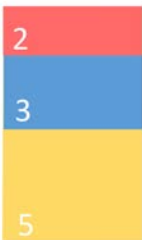

WALKING TRAILS

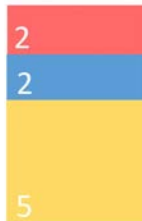

BASKETBALL

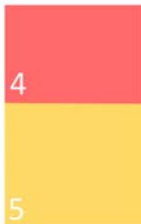

OUTDOOR FITNESS





# TODAY'S DISCUSSION: COMMUNITY CENTER

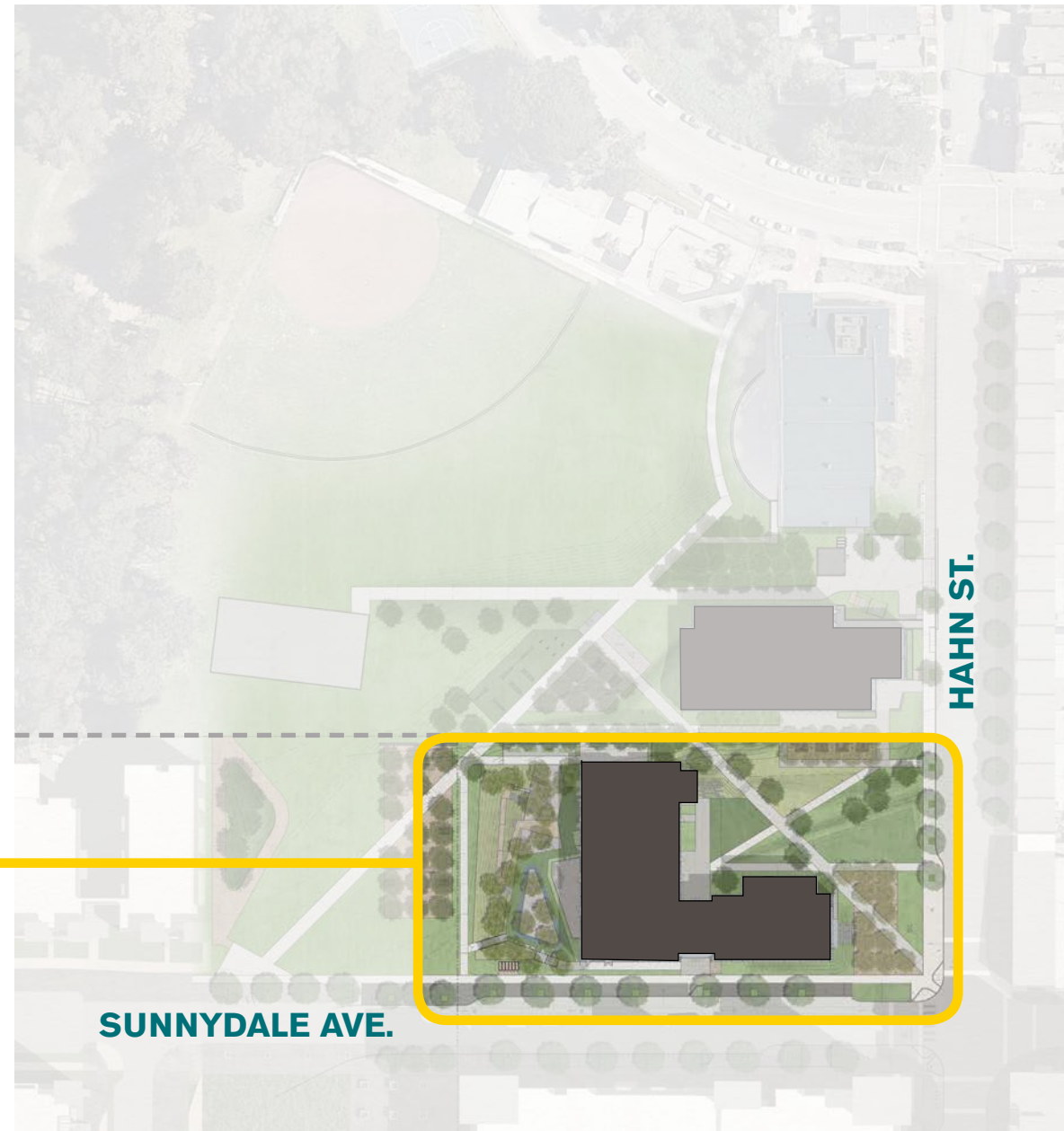

# COMMUNITY CENTER: HOW IT FEELS



INVITING



BRIGHT + SAFE



FAMILY-FRIENDLY



COMMUNAL



# COMMUNITY CENTER: WHAT HAPPENS INSIDE



COMMUNITY SPACE



WU YEE  
CHILDREN'S SERVICES



BOYS + GIRLS CLUB



# COMMUNITY CENTER: WHAT HAPPENS OUTSIDE



FAMILY GATHERINGS

ACTIVITIES FOR  
ALL AGES

PLAY + LEARNING

CONNECTION TO  
NATURE



# COMMUNITY CENTER OVERVIEW





# COMMUNITY CENTER: LANDSCAPE DESIGN

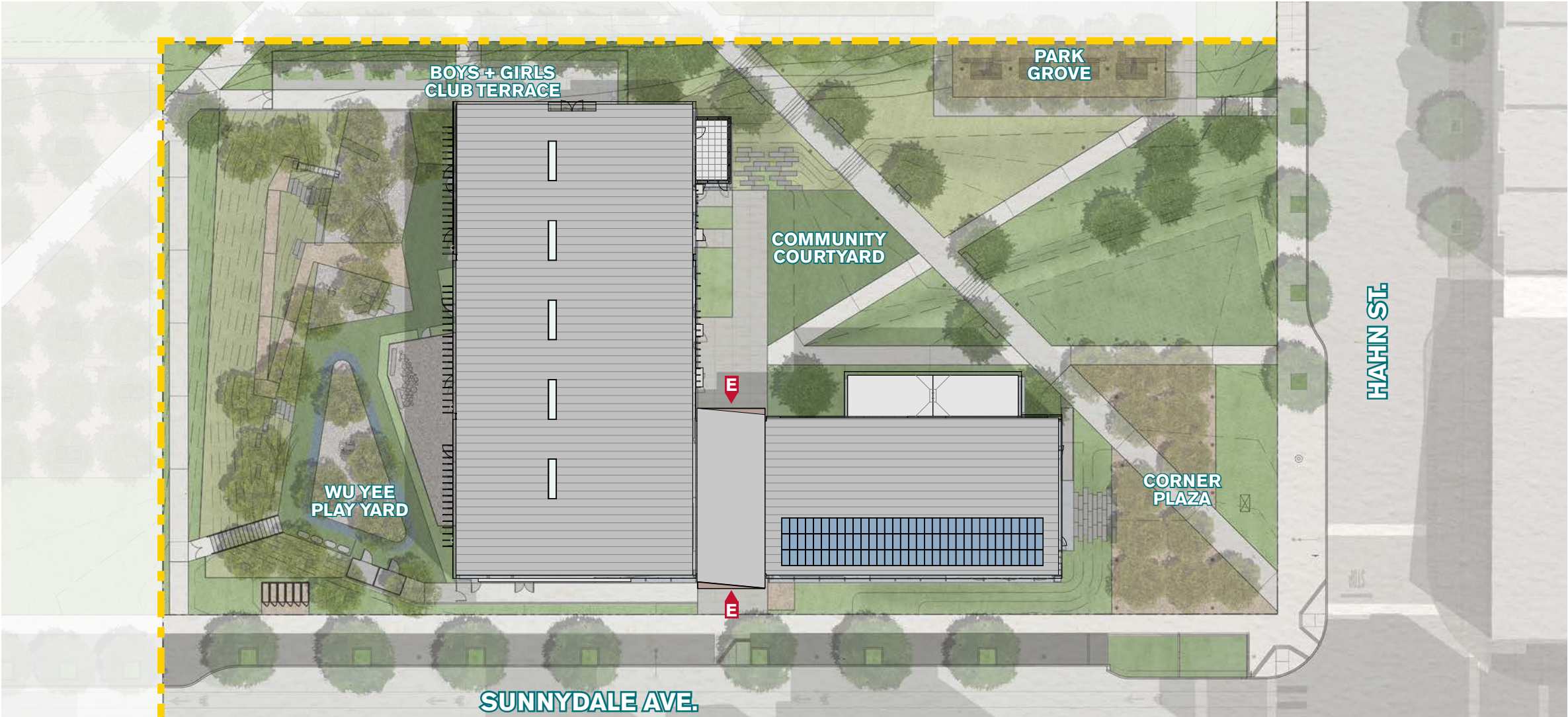



## An architectural rendering of a modern park or plaza. A wide, light-colored paved walkway leads from the foreground into the distance, flanked by young trees and low-lying greenery. On the left, a modern building with large glass windows and a flat roof is visible. Several people are depicted: a man in a blue shirt stands near a wooden bench in the foreground; a group of people sits on a set of steps leading up to the building; other individuals are walking or sitting on benches further down the path. The scene is bright and sunny, with lush green trees and plants. A black lamppost stands on the right side of the path.



# COMMUNITY COURTYARD





# PARK GROVE





# COMMUNITY CENTER: FIRST FLOOR

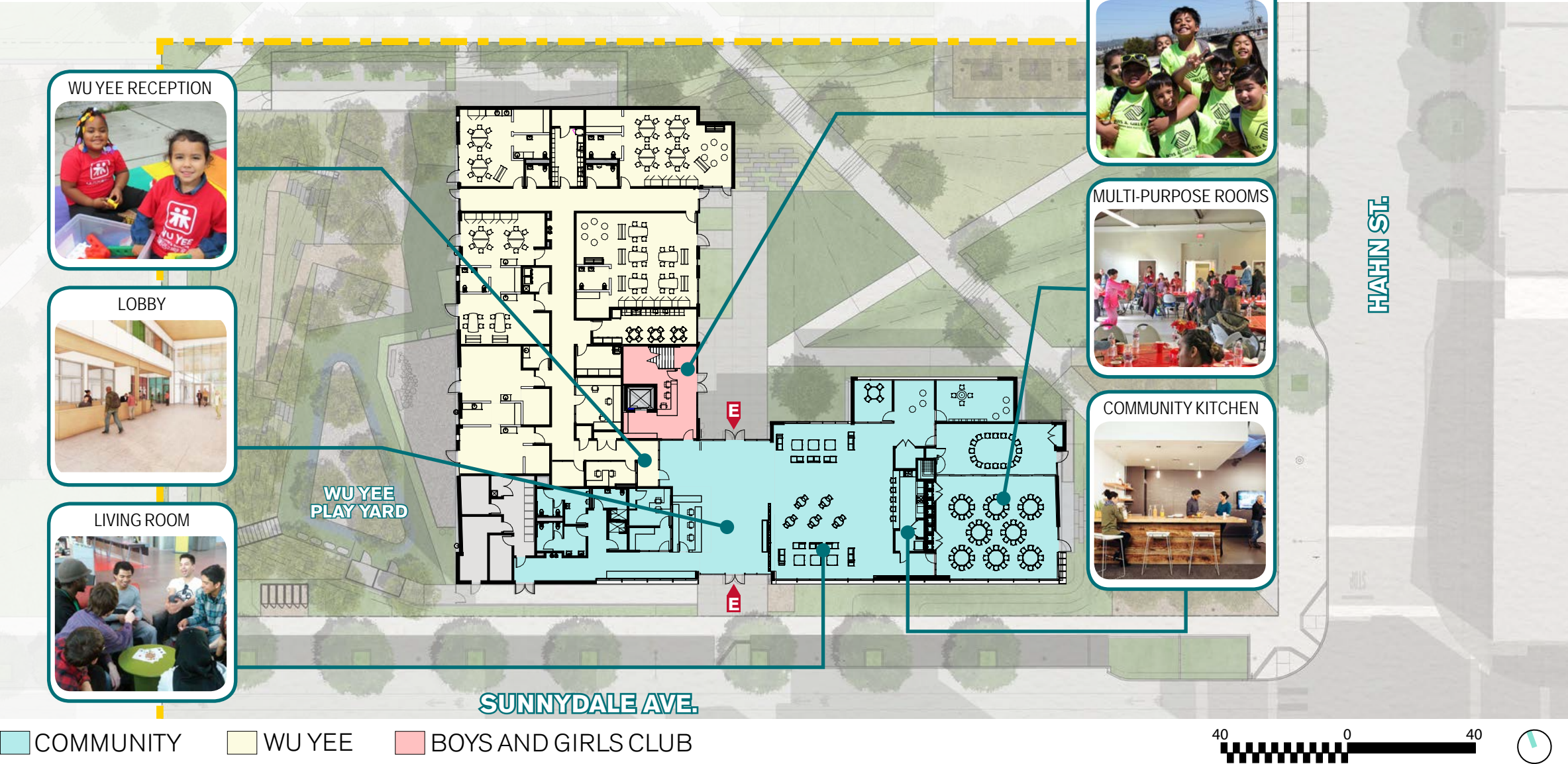



# COMMUNITY CENTER: SECOND FLOOR

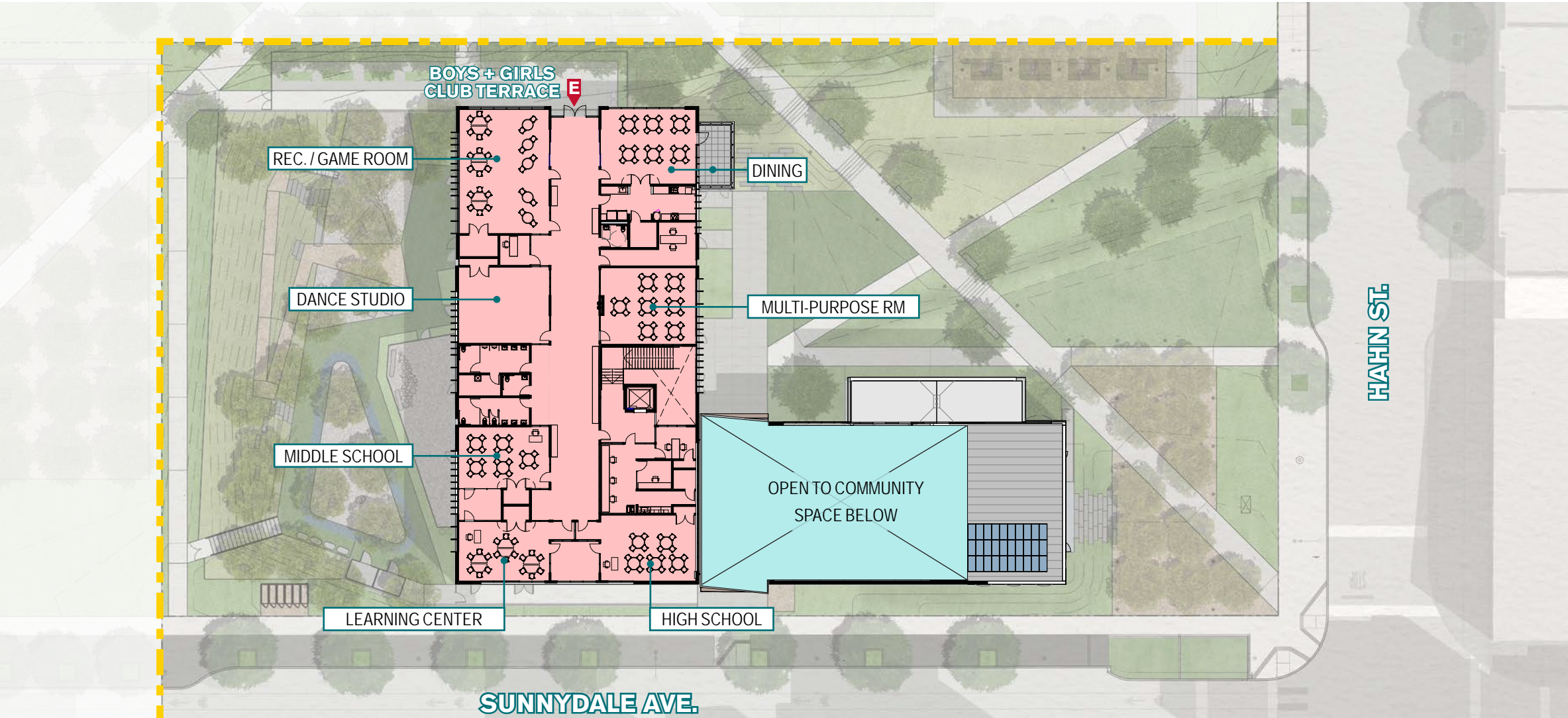

COMMUNITY WU YEE BOYS AND GIRLS CLUB

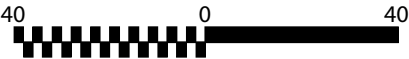



# CORNER OF SUNNYDALE + HAHN





# COMMUNITY CENTER FROM SUNNYDALE AVE





# COMMUNITY CENTER VIEW FROM PARK GROVE





# COMMUNITY CENTER LOBBY





## COMMUNITY VISUAL PALETTE

Be part of an emerging, exciting and diverse San Francisco development with rich history and culture in a dynamic urban environment surrounded by natural beauty.





# COMMUNITY VISUAL PALETTE



RICH CULTURE + HISTORY

NATURAL BEAUTY

DYNAMIC + URBAN



# VIEW FROM PARK LOOKING TOWARDS SUNNYDALE + HAHN





# PROJECT DISCUSSION



## Raise your hand to speak

Using the Zoom hand raising function.

Everyone will be muted until they are called on to speak.  
Please share your name the first time you speak.

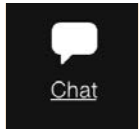

## Enter your questions or comments into the chat.

Questions will be read and answered aloud during the discussion after the presentation.





# PROJECT DISCUSSION



Raise Hand

*Raise your hand to speak*



Chat

*Enter your questions or comments into the chat.*

1. Does the programming and design represent our work together?
2. What do you like most about the community programming and design that we did together?
3. What fine-tuning would you recommend or like to see?





# NEXT STEPS



**We will be submitting the Community Center design to the Planning Department for review**

**To view this presentation again please visit:**  
[www.gosunnydale.org/community](http://www.gosunnydale.org/community)

**Please contact us if you have any questions!**  
[neighborhoodhub@mercyhousing.org](mailto:neighborhoodhub@mercyhousing.org)  
415.355.7133

**Thank You!**